

DIN 934 Hexagon Fullnuts

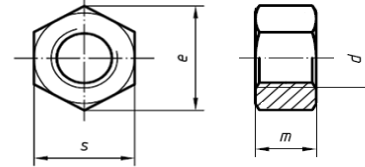

DIN 934 Hexagon Fullnuts																	
d	M1	M1.2	M1.4	M1.6	M1.7	M2	M2.3	M2.5	M2.6	M3	M3.5	M4	M5	M6	M7	M8	M10
m	0.8	1	1.2	1.3	1.4	1.6	1.8	2	2	2.4	2.8	3.2	4	5	5.5	6.5	8
S	2.5	3	3	3.2	3.5	4	4.5	5	5	5.5	6	7	8	10	11	13	17
Pitch	0.25	0.25	0.30	0.35	0.35	0.40	0.40	0.45	0.45	0.50	0.60	0.70	0.80	1.00	1.00	1.25	1.50

d	M12	M14	M16	M18	M20	M22	M24	M27	M30	M33	M36	M39	M42	M45	M48	M52
m	10	11	13	15	16	18	19	22	24	26	29	31	34	36	38	42
S	19	22	24	27	30	32	36	41	46	50	55	60	65	70	75	80
Pitch	1.75	2.00	2.00	2.50	2.50	2.50	3.00	3.00	3.50	3.50	4.00	4.00	4.50	4.50	5.00	5.00

Materials	Range	Finish
Steel Grade 6 & 8	M1 - 110	Self Colour
Steel Grade 6 & 8	M2.5 - M80	Zinc (CR3)
Steel Grade 6 & 8	Please Enquire	Galvanised
Steel Grade 10	M5 - M64	Self Colour
Steel Grade 10	M8- M64	Galvanised
Steel Grade 12	M6 - M48	Self Colour
<i>For Diameters: M56 - M110 Please Enquire</i>		
Stainless Steel	M1 - M56	A2
Stainless Steel	M1.4 - M56	A4
Brass	M2 -24	Self Colour

INFORMATION AND DRAWINGS PROVIDED ARE FOR REFERENCE ONLY